

TS958 and TS970

Digital Control Systems for Industrial Doors

- Limit switch setting from ground level
- Programmable Door Maintenance Indicator
- Plug connections between control panel and drive unit
- Load monitoring in the open direction (sectional doors only)
- Digital display of door status and/or fault diagnostic
- Operations cycle counter (non re-settable)
- Certified to BS EN 12453



Digital Features

For use with the Guthrie Douglas range of drives incorporating digital limits (DES) the TS958 and TS970 allow easy and rapid setting of limit switch positions and door parameters from ground level. With the introduction of digital limits both the TS958 and TS970 have the facility to monitor the load on the door in the open direction. This feature on certain designs of door prevents objects or persons being accidentally lifted as well as preventing people intentionally riding on a door when opening.

As with the other Guthrie Douglas controls the TS958 and TS970 now include as standard a programmable door maintenance indicator. This allows the installer to set a maintenance interval to suit the door and its application of between 1000 to 99000 operations on completion of which the control will tell the customer that the door needs servicing.

Simplifying on-site installation

The drive motor and limits are connected to the TS control by plug-in protected cable (supplied separately, length 3, 5, 7, 9 or 13m). The spiral cable for connecting the TS control to slack-wire, pedestrian door switches and safety edge (TS970 only) is also supplied

with plug-in connections.

Unnecessary callbacks are minimised as the customer can now read back the doors status using the digital display, which is visible through the new enclosure lid. If a return visit is required then door adjustments can be carried out without accessing the drive unit therefore negating the need for expensive access equipment. In the case of the TS970 some door adjustments can be carried out automatically for instance re-adjustment of the close limit to allow for cable stretch and/or for changes in finished floor level.

Enclosure

The purpose built enclosure with a fully protected printed-circuit board meets the IP65 class for dust and

moisture protection. The enclosure has pre-drilled entries and flexible feet for mounting on uneven surfaces and incorporates open, close and stop buttons with the provision for installing a key switch and/or latching stop button if required.

Meeting the Standards

The TS958 and TS970 meet the requirements of the BS EN 12453 and the introduction of a programmable maintenance indicator further enhances the safety regime for the user. According to whether the intended users are trained or not and whether the door is in a public area or not, determines the degree of safety required.

Door User	Control Unit	Obligatory Accessories	Function
Trained user only Not in a public area	TS958 In sight of door	N/A	Impulse Open Hold to run Close
Trained user In a public area	TS958 In sight of door	Key Switch on/off	Impulse Open Hold to run Close
Trained user In a public area	TS970 In sight of door	Safety Edge	Impulse Open Impulse Closed
General Public	TS970 In/out of sight of door	Safety Edge and Photo Beam	Impulse Open Impulse Closed

Note: Doors that can lift a person require additional safety devices

Control Panel TS958

The features of the TS958 control include:

- Limit switch and door parameter setting from ground level
- Programmable Door Maintenance Indicator, which can be selected to either display only or display and change the door operation when service is due
- Load monitoring in the open direction
- Digital display of door status and/or fault diagnostic
- Operations cycle counter (non re-settable)
- Three selectable door functions
- Connection for a plug-in spiral cable for cable break or slack wire switches or pass door switch on sectional doors

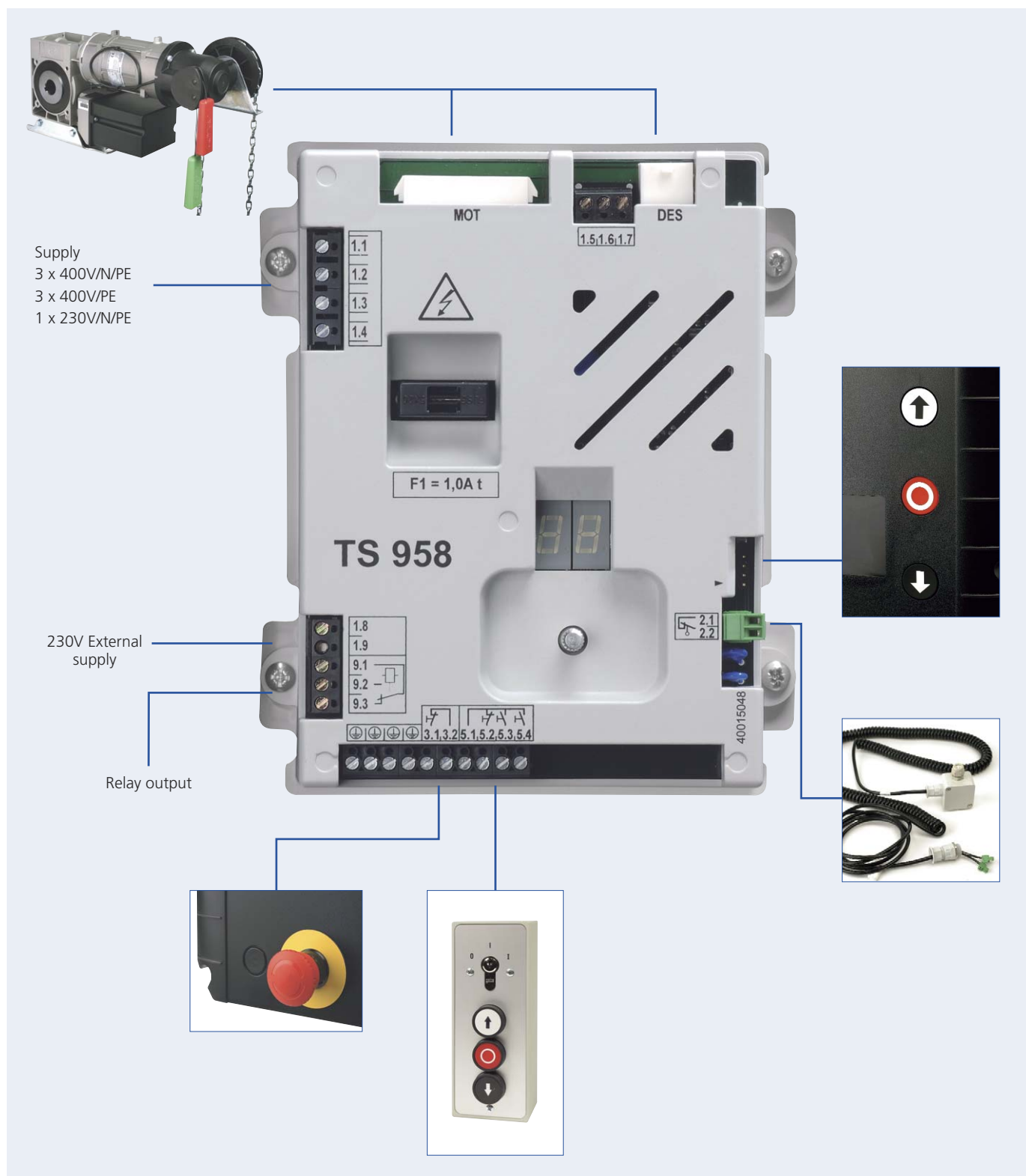

Accessories for use with Control Panels



GE23029/030
Protected cable (3m)

GE23029/050
Protected cable (5m)

GE23029/070
Protected cable (7m)

GE23029/090
Protected cable (9m)

GE23029/130
Protected cable (13m)



KSR4P
Fraba safety edge kit (<6m)

KSR4P/10
Fraba safety edge kit (<10m)

KSR6P*
Wireless Safety Edge Kit (<6m)

KSR6P/10
Wireless Safety Edge Kit (<10m)



GF10045
Edge profile, roller shutters

GF10050
Bump stop for roller shutters

GF10085
Edge profile, sectional doors

GF10095
Bump stop for sectional doors

GF10100
Edge profile, high speed doors

GF10110
Bump stop for high speed doors

GF40594 Mounting rail 3m

GF/AC2001 Draw wire (7m)



VR/R2E
Receiver 433MHz, 2 Channel rolling code

VR/TF2E*
Key-fob transmitter 2 Channel 433MHz

VR/TF4E*
Key-fob transmitter 4 Channel 433MHz

VR/TW4E*
Transmitter 4 Channel 433MHz



VR/60733*
Vehicle mounted transmitter, 1 Channel 433MHz

VR/60734
Vehicle mounted transmitter, 2 Channel 433MHz



GE46390*
Pull switch, for wall or ceiling mounting with 2.5m chain

ELS 145FH
Shoot bolt interlock switch



GE34615*
Panel mounted latching stop button

GE34616*
Panel mounted key switch



JAPZ4-IR
Remote Key Switch with 3 push buttons



IFALCONXL
Industrial motion sensor (3.5m high)

IFALCON*
Industrial motion sensor (<7m high)



ICONDOR
Motion and presence sensor (<6m high)

IREMOTE*
Remote control setting



PES135/6*
Polarised reflex photo-beam (<6m range)

PES135/9
Polarised reflex photo-beam (<9m range)

PES132/20
Through-beam sender and receiver (<20m range)



GE301955*
Traffic indicator assembly, red and green

*ILLUSTRATED

Guthrie Douglas

Guthrie Douglas Limited
Unit 1, Titan Business Centre,
Spartan Close,
Warwick, UK CV34 6RR
Tel: (+44) 01926 452 452
Fax: (+44) 01926 336 417
E-mail: sales@guthriedouglas.com



Assessed to ISO 9001: 2008
Certificate No 193